

# SIT CLIM Insulated Pipe Clamp with Rubber Ends



## FEATURES

Pre-mounted with steel two screw pipe clamp

Fire rating B2 acc. to DIN 4102-1

Fire rating M1 acc. to NFP 92-501

## SPECIFICATIONS

<b>Thermal Conductivity:</b>	0.03 W/m-K @ 10 °C
<b>Density:</b>	80 kg/m³
<b>Compressive Strength:</b>	520 kPa @ 23 °C
<b>Finish:</b>	Electrogalvanized
<b>Material:</b>	Steel;Polyisocyanurate
<b>Temperature:</b>	-40 to 90 °C

Table 1/1

Catalog Number	Article Number	Insulation Thickness	Outer Diameter (OD)	NB/DN	Rod Size (RS)	B
SCLI19I0076	581670	19 mm	76 mm	65	M8, M10	50 mm
SCLI19I0089	581680	19 mm	89 mm	80	M8, M10	50 mm
SCLI19I0102	581690	19 mm	102 mm		M8, M10	50 mm

CatalogNumber	Article Number	Insulation Thickness	Outer Diameter (OD)	NB/DN	Rod Size (RS)	B
SCLI19I0108	581700	19 mm	108 mm		M8, M10	50 mm
SCLI19I0114	581710	19 mm	114 mm	100	M8, M10	50 mm
SCLI19I0125	581715	19 mm	125 mm		M8, M10	50 mm
SCLI19I0133	581720	19 mm	133 mm		M8, M10	50 mm
SCLI19I0139	581725	19 mm	139.7 mm	125	M8, M10	50 mm
SCLI19I0160	581730	19 mm	160 mm		M8, M10	50 mm
SCLI19I0168	581735	19 mm	168.3 mm	150	M8, M10	50 mm
SCLI13I0010	580091	13 mm	10 mm		M8, M10	50 mm
SCLI13I0012	580092	13 mm	12 mm		M8, M10	50 mm
SCLI13I0016	580093	13 mm	15 mm		M8, M10	50 mm
SCLI13I0017	580100	13 mm	17 mm	10	M8, M10	50 mm
SCLI13I0018	580105	13 mm	18 mm		M8, M10	50 mm
SCLI13I0021	580110	13 mm	21 mm	15	M8, M10	50 mm
SCLI13I0022	580111	13 mm	22 mm		M8, M10	50 mm
SCLI13I0025	580112	13 mm	25 mm		M8, M10	50 mm
SCLI13I0027	580120	13 mm	27 mm	20	M8, M10	50 mm
SCLI13I0028	580121	13 mm	28 mm		M8, M10	50 mm
SCLI13I0030	580122	13 mm	30 mm		M8, M10	50 mm

CatalogNumber	Article Number	Insulation Thickness	Outer Diameter (OD)	NB/DN	Rod Size (RS)	B
SCLI13I0034	580130	13 mm	34 mm	25	M8, M10	50 mm
SCLI13I0035	580135	13 mm	35 mm		M8, M10	50 mm
SCLI13I0042	580140	13 mm	42 mm	32	M8, M10	50 mm
SCLI13I0044	580145	13 mm	44.5 mm		M8, M10	50 mm
SCLI13I0049	580150	13 mm	49 mm	40	M8, M10	50 mm
SCLI13I0054	580151	13 mm	54 mm		M8, M10	50 mm
SCLI13I0057	580152	13 mm	58 mm		M8, M10	50 mm
SCLI13I0060	580160	13 mm	60 mm	50	M8, M10	50 mm
SCLI13I0064	580170	13 mm	64 mm		M8, M10	50 mm
SCLI13I0070	581600	13 mm	70 mm		M8, M10	50 mm
SCLI13I0076	581610	13 mm	76 mm	65	M8, M10	50 mm
SCLI13I0089	581620	13 mm	89 mm	80	M8, M10	50 mm
SCLI13I0102	581630	13 mm	102 mm		M8, M10	50 mm
SCLI13I0108	581640	13 mm	108 mm		M8, M10	50 mm
SCLI13I0114	581650	13 mm	114 mm	100	M8, M10	50 mm
SCLI19I0010	580270	19 mm	10 mm		M8, M10	50 mm
SCLI19I0012	580280	19 mm	12 mm		M8, M10	50 mm
SCLI19I0016	580290	19 mm	15 mm		M8, M10	50 mm

CatalogNumber	Article Number	Insulation Thickness	Outer Diameter (OD)	NB/DN	Rod Size (RS)	B
SCLI19I0017	580300	19 mm	17 mm	10	M8, M10	50 mm
SCLI19I0018	580305	19 mm	18 mm		M8, M10	50 mm
SCLI19I0021	580310	19 mm	21 mm	15	M8, M10	50 mm
SCLI19I0022	580311	19 mm	22 mm		M8, M10	50 mm
SCLI19I0025	580312	19 mm	25 mm		M8, M10	50 mm
SCLI19I0027	580320	19 mm	27 mm	20	M8, M10	50 mm
SCLI19I0028	580321	19 mm	28 mm		M8, M10	50 mm
SCLI19I0030	580322	19 mm	30 mm		M8, M10	50 mm
SCLI19I0034	580330	19 mm	34 mm	25	M8, M10	50 mm
SCLI19I0035	580335	19 mm	35 mm		M8, M10	50 mm
SCLI19I0042	580340	19 mm	42 mm	32	M8, M10	50 mm
SCLI19I0044	580345	19 mm	44.5 mm		M8, M10	50 mm
SCLI19I0049	580350	19 mm	49 mm	40	M8, M10	50 mm
SCLI19I0054	580351	19 mm	54 mm		M8, M10	50 mm
SCLI19I0057	580352	19 mm	57 mm		M8, M10	50 mm
SCLI19I0060	580360	19 mm	60 mm	50	M8, M10	50 mm
SCLI19I0064	580365	19 mm	64 mm		M8, M10	50 mm
SCLI19I0070	581660	19 mm	70 mm		M8, M10	50 mm

DIAGRAMS

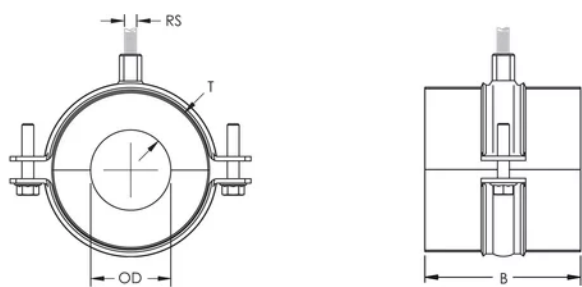

WARNING

nVent products shall be installed and used only as indicated in nVent's product instruction sheets and training materials. Instruction sheets are available at [www.nvent.com](http://www.nvent.com) and from your nVent customer service representative. Improper installation, misuse, misapplication or other failure to completely follow nVent's instructions and warnings may cause product malfunction, property damage, serious bodily injury and death and/or void your warranty.

North America

+1.800.753.9221  
Option 1 – Customer Care  
Option 2 – Technical  
Support

Europe

Netherlands:  
+31 800-0200135  
France:  
+33 800 901 793

Europe

Germany:  
800 1890272  
Other Countries:  
+31 13 5835404

APAC

Shanghai:  
+ 86 21 2412 1618/19  
Sydney:  
+61 2 9751 8500



Our powerful portfolio of brands:

CADDY   ERICO   HOFFMAN   ILSCO   SCHROFF   TRACHTE

