

Flat Washer



FEATURES

Use under the head of a bolt or nut in order to distribute the fastener load over a wider surface area

SPECIFICATIONS

Complies With: DIN 933

Table 1/1

Catalog Number	Article Number	Material	Finish	Hole Size (HS)	Diameter (Ø)	Thickness (T)
01106EG	592390	Steel	Electrogalvanized	6.4 mm	12 mm	1.6 mm
01106S4	592480	Stainless Steel 304 (EN 1.4301)		6.4 mm	12 mm	1.6 mm
01108EG	592400	Steel	Electrogalvanized	8.4 mm	16 mm	1.6 mm
01108S4	592490	Stainless Steel 304 (EN 1.4301)		8.4 mm	16 mm	1.6 mm
01110EG	592410	Steel	Electrogalvanized	10.5 mm	20 mm	2 mm
01110HD	592415	Steel	Hot-Dip Galvanized	10.5 mm	21 mm	2 mm

CatalogNumber	Article Number	Material	Finish	Hole Size (HS)	Diameter (Ø)	Thickness (T)
01110S4	592500	Stainless Steel 304 (EN 1.4301)		10.5 mm	20 mm	2 mm
01112EG	592420	Steel	Electrogalvaniz ed	13 mm	24 mm	2.5 mm
01112HD	592425	Steel	Hot-Dip Galvanized	13 mm	24 mm	2.5 mm
01112S4	592510	Stainless Steel 304 (EN 1.4301)		13 mm	24 mm	2.5 mm
01116EG	400448	Steel	Electrogalvaniz ed	17 mm	30 mm	3 mm

DIAGRAMS

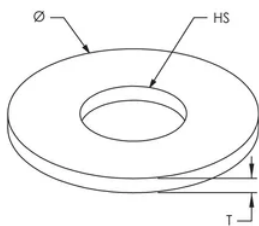

WARNING

nVent products shall be installed and used only as indicated in nVent's product instruction sheets and training materials. Instruction sheets are available at www.nvent.com and from your nVent customer service representative. Improper installation, misuse, misapplication or other failure to completely follow nVent's instructions and warnings may cause product malfunction, property damage, serious bodily injury and death and/or void your warranty.

North America

+1.800.753.9221

Option 1 – Customer Care

Option 2 – Technical

Support

Europe

Netherlands:

+31 800-0200135

France:

+33 800 901 793

Europe

Germany:

800 1890272

Other Countries:

+31 13 5835404

APAC

Shanghai:

+ 86 21 2412 1618/19

Sydney:

+61 2 9751 8500



Our powerful portfolio of brands:

CADDY

ERICO

HOFFMAN

ILSCO

SCHROFF

TRACHTE

