

150M Standard U-Bolt

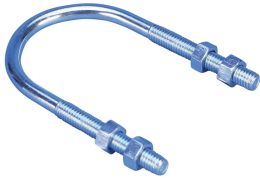

FEATURES

Pipe support for general piping applications

Comes complete with 4 nuts (2 installed on each end)

Conforms with Federal Specification WW-H-171 (Type 24), Manufacturers Standardization Society ANSI®/MSS-SP-58 (Type 24)

SPECIFICATIONS

Table 1/2

Catalog Number	Material	Finish	Outer Diameter (OD)	Screw Length (L)	A	B
150M0100EG	Steel	Electrogalvanized	33.4 mm	60.5mm	93.7 mm	39.8 mm
150M0100PL	Steel	Plain	33.4 mm	60.5mm	93.7 mm	39.8 mm
150M0100S4	Stainless Steel 304 (EN 1.4301)		33.4 mm	60.5mm	93.7 mm	39.8 mm
150M0125EG	Steel	Electrogalvanized	42.2 mm	60.5mm	104.8 mm	51.7 mm
150M0125PL	Steel	Plain	42.2 mm	60.5mm	104.8 mm	51.7 mm
150M0125S4	Stainless Steel 304 (EN 1.4301)		42.2 mm	60.5mm	104.8 mm	51.7 mm

CatalogNumber	Material	Finish	Outer Diameter (OD)	Screw Length (L)	A	B
150M0150EG	Steel	Electrogalvanized	48.3 mm	63.5mm	109.6 mm	57.8 mm
150M0150PL	Steel	Plain	48.3 mm	63.5mm	109.6 mm	57.8 mm
150M0150S4	Stainless Steel 304 (EN 1.4301)		48.3 mm	63.5mm	109.6 mm	57.8 mm
150M0200EG	Steel	Electrogalvanized	60.3 mm	63.5mm	122.38 mm	69.9 mm
150M0200PL	Steel	Plain	60.3 mm	63.5mm	122.38 mm	69.9 mm
150M0200S4	Stainless Steel 304 (EN 1.4301)		60.3 mm	63.5mm	122.38 mm	69.9 mm
150M0250EG	Steel	Electrogalvanized	73 mm	76.2mm	146.1 mm	85.7 mm
150M0250PL	Steel	Plain	73 mm	76.2mm	146.1 mm	85.7 mm
150M0250S4	Stainless Steel 304 (EN 1.4301)		73 mm	76.2mm	146.1 mm	85.7 mm
150M0300EG	Steel	Electrogalvanized	88.9 mm	76.2mm	160.3 mm	101.6 mm
150M0300PL	Steel	Plain	88.9 mm	76.2mm	160.3 mm	101.6 mm
150M0300S4	Stainless Steel 304 (EN 1.4301)		88.9 mm	76.2mm	160.3 mm	101.6 mm
150M0400EG	Steel	Electrogalvanized	114.3 mm	76.2mm	185.7 mm	127 mm
150M0400PL	Steel	Plain	114.3 mm	76.2mm	185.7 mm	127 mm
150M0400S4	Stainless Steel 304 (EN 1.4301)		114.3 mm	76.2mm	185.7 mm	127 mm
150M0500EG	Steel	Electrogalvanized	141.3 mm	76.2mm	211.1 mm	154 mm
150M0500PL	Steel	Plain	141.3 mm	76.2mm	211.1 mm	154 mm

CatalogNumber	Material	Finish	Outer Diameter (OD)	Screw Length (L)	A	B
150M0500S4	Stainless Steel 304 (EN 1.4301)		141.3 mm	76.2mm	211.1 mm	154 mm
150M0600EG	Steel	Electrogalvanized	168.3 mm	95.3mm	257.1 mm	184.2 mm
150M0600PL	Steel	Plain	168.3 mm	95.3mm	257.1 mm	184.2 mm
150M0600S4	Stainless Steel 304 (EN 1.4301)		168.3 mm	95.3mm	257.1 mm	184.2 mm
150M0800EG	Steel	Electrogalvanized	219.1 mm	95.3mm	308 mm	235 mm
150M0800PL	Steel	Plain	219.1 mm	95.3mm	308 mm	235 mm
150M0800S4	Stainless Steel 304 (EN 1.4301)		219.1 mm	95.3mm	308 mm	235 mm
150M1000EG	Steel	Electrogalvanized	273.1 mm	101.6mm	369.8 mm	292.1 mm
150M1000PL	Steel	Plain	273.1 mm	101.6mm	369.8 mm	292.1 mm
150M1000S4	Stainless Steel 304 (EN 1.4301)		273.1 mm	101.6mm	369.8 mm	292.1 mm
150M1200EG	Steel	Electrogalvanized	323.9 mm	108mm	430.1 mm	346.1 mm
150M1200PL	Steel	Plain	323.9 mm	108mm	430.1 mm	346.1 mm
150M1200S4	Stainless Steel 304 (EN 1.4301)		323.9 mm	108mm	430.1 mm	346.1 mm

Table 2/2

Catalog Number	Static Load
150M0100EG	1930N
150M0100PL	1930N

Catalog Number	Static Load
150M0100S4	1930N
150M0125EG	4800N
150M0125PL	4800N
150M0125S4	4800N
150M0150EG	4800N
150M0150PL	4800N
150M0150S4	4800N
150M0200EG	4800N
150M0200PL	4800N
150M0200S4	4800N
150M0250EG	8900N
150M0250PL	8900N
150M0250S4	8900N
150M0300EG	8900N
150M0300PL	8900N
150M0300S4	8900N
150M0400EG	8950N
150M0400PL	8950N

Catalog Number	Static Load
150M0400S4	8950N
150M0500EG	8950N
150M0500PL	8950N
150M0500S4	8950N
150M0600EG	14350N
150M0600PL	14350N
150M0600S4	14350N
150M0800EG	14350N
150M0800PL	14350N
150M0800S4	14350N
150M1000EG	21450N
150M1000PL	21450N
150M1000S4	21450N
150M1200EG	29900N
150M1200PL	29900N
150M1200S4	29900N

DIAGRAMS

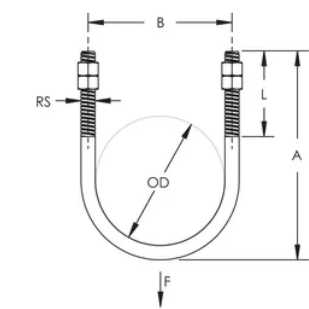

WARNING

nVent products shall be installed and used only as indicated in nVent's product instruction sheets and training materials. Instruction sheets are available at www.nvent.com and from your nVent customer service representative. Improper installation, misuse, misapplication or other failure to completely follow nVent's instructions and warnings may cause product malfunction, property damage, serious bodily injury and death and/or void your warranty.

North America

+1.800.753.9221
Option 1 – Customer Care
Option 2 – Technical
Support

Europe

Netherlands:
+31 800-0200135
France:
+33 800 901 793

Europe

Germany:
800 1890272
Other Countries:
+31 13 5835404

APAC

Shanghai:
+ 86 21 2412 1618/19
Sydney:
+61 2 9751 8500



Our powerful portfolio of brands:

CADDY ERICO HOFFMAN ILSCO SCHROFF TRACHTE

